

METFRAME[®]

Ceiling & Drywall Profiles

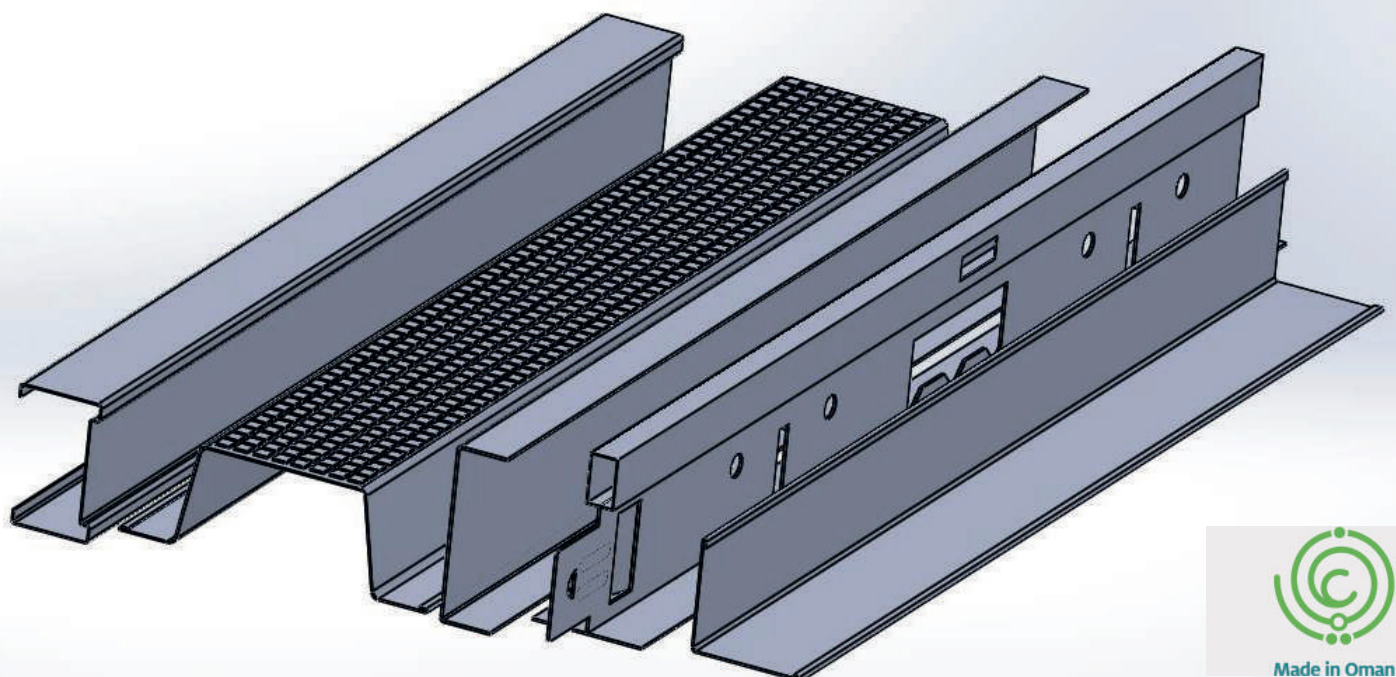

Made in Oman

Oman



***METFRAME CEILING & DRYWALL PROFILES
MADE IN OMAN***

ميتفرام *METFRAME*

MADE IN OMAN صنع في عمان

About us

Quality Management System

Projects Supplied

Drywall Ceiling System

Drywall Partition System

Installation Method

Our Other Products

About Us

KINGDOM ENTERPRISES [Kingdom of Cargo and Trading] is a Muscat based company founded by a team of professionals having years of work experience in the field of building materials and plasterworks. It was started with a very clear vision to deliver right quality materials in a time bound schedule.

With our long working experience in the field, we know exact requirements of our quality conscious customers and accordingly we import top quality products directly from reputed manufacturers & trading houses all over the world. We offer right products to suit the budget exact specifications of the customer.

We at KINGDOM ENTERPRISES believe that in order to properly service our customer we must establish and maintain individual relationships. It is necessary to completely understand both the people we deal with and the special needs of different construction projects. In the construction industry, situations change from day to day and no job ever goes exactly as originally planned.

We train our employees to be open to these changes and quick to respond in order to help our customers keep their clients happy and their projects moving ahead.

We also feel that it is important to maintain strong ties and open lines of communication with our vendors so that we may have product information and manufacturers support readily available for our customers. Incorporating these ideas into our everyday operations and the mindset of our staff allows us to build long-lasting relationships that are beneficial to all involved.

We are the first manufacturer in Oman for gypsum drywall profiles, our annual production capacity is 6000 metric tons. We are focusing on local market and export business in many sectors of global market. We are engaged in production of gypsum drywall profile to suit in applications, to provide solutions in diverse market sectors, which includes commercial building projects, residential units, hospitals, airports, hotels and education facilities.

The product line is especially beneficial for consultants, architects, building contractors and developers, all of our products certified and approved in major projects in Oman, our policy is to provide high quality products to our clients.

It is this philosophy that has enabled us to grow and become a known player in our industry.

“Vision makes money, Money doesn’t make vision”

Outlining VISION:

KINGDOM ENTERPRISES [Kingdom of Cargo and Trading] is to become one of the best business establishments by providing products with latest technology and services with advanced work methods to all our customers.

MISSION Statement:

The mission of KINGDOM ENTERPRISES [Kingdom of Cargo and Trading] is to provide quality products and render unparalleled and excellent services on time to all our customers according to their specifications, needs and entirely to their satisfaction through continual quality improvement program engaging qualified and experienced professionals.

Setting VALUES:

Integrity- to be open, honest and to honour commitments

Excellence- to strive for best results

Responsiveness- to listen to people we work with and serve and act in a timely and sensitive manner

Learning- to increase knowledge and understanding at the workplace and in the community

Fairness- to apply unbiased judgement and fair deal

Leadership- to set examples those others will choose to follow

METFRAME ميتفرام brand logo is approved by the Oman chamber of commerce & industry, as a manufacturer of metal products in the region.

Quality Management System

KINGDOM ENTERPRISES [Kingdom of Cargo and Trading] is dedicated to the quality aspects which ensure that its products and services fully meet the requirements of its customers. Our maintain priorities are efficiency and customer satisfaction. To the end, we are committed to undertake the following.

- Understand our customer needs and improve our service to facilitate growth.***
- Develop our production technology to meet our customers expectations and market demand, our machinery including fast high quality roll forming machines as well as specialized equipment for pressing, bending, printing and notching.***
- Our metal profiles are delicate the reliability, quality and durability due to the standard manufacturing process. In the industry our clients recognize us as a leading manufacture with highly competitive prices.***
- Promote a workplace in which our staff are properly trained and developed to comply with the applicable standards and procedures.***
- Continually comply with the requirements of ISO 9001-2008 and improve the effectiveness of our Quality Management System.***

By Management

PROJECTS SUPPLIED IN OMAN SOME OF US

- MUSCAT MEGA MALL (AL MAABELLA)**
- MALABAR DAYS RESTURANT (AL MAABELLA)**
- GULF COLLAGE (AL MAABELLA)**
- MALL MART (AL MAABELLA & AMERAT)**
- AL AIN GIFT MARKETS (AL MAABELLA)**
- BOULEVARD MALL OMAN (AL KHOUD)**
- MALL OF MUSCAT (AL MAABELLA)**
- NESTO HYPERMARKET (BARKA & AL HAIL)**
- PAN FURNITURES (GHALA)**
- OMAN RACING CLUB (AIRPORT HEIGHTS)**
- TMK GULF PIPE INDUSTRY PHASE V (SOHAR)**
- NLG (IBRI)**
- ARINA HOME (AL SEEB)**
- LIYAQAT RESIDENCE (AL KHOUD)**
- AL MAUTSIM MOTORS (AL MAABELA)**
- A`SHARQIYAH UNIVERSITY (IBRA)**

EXPORTS

- RAK – UAE**
- DOHA QATAR**
- AFRICA (EAST & WEST)**

Technical Data Sheets of Dry Wall Ceiling System

Description of the products: Dry Wall Ceiling System

Applicable Standards: Galvanized / Galvalume Steel

BS EN 10346:2009 -DX51(formerly BS EN 10142:1991)

Material Identification: G.I / G.L Steels consisting of the Mainchannel, Furring channel and Perimeter Angle (Wall Angle).

Product Identification:

Description	Dimension (mm)	Length (mm)	Thickness (mm)	Pcs/Pallet	Application
Main Channel	11 x 38 x 11	3000	0.35 - 1.0mm	500	Main support for furring channel
Furring Channel	12 x 22 x 35 x 22 x12	3000	0.35 - 1.0mm	500	Support section where gypsum board is fixed.
Perimeter Angle	25 x 25	3000	0.35 - 1.0mm	1000	Fixed around the wall to receive ends of furring channels and outer edges of gypsum board.

*Custom lengths are available upon request.

Features and Uses:

- Quick installation.
- Hide pipes, wires and ductwork.
- Improved Sound proofing.
- Resistant to moisture and mould.

Material Specification: Galvanized / Galvalume Steel

Mechanical Properties

Specification and Grade: ASTM A653:2018/CS Type A

Treatment: Chromated (6) & Unoiled

Yield Strength: 300 Mpa - 400 Mpa

Tensile Strength: 270 Mpa - 500 Mpa

Elongation: 22% - 37 % at 50 GL

Hardness (HRB): 60 – 65

Manufacturing Standard: ASTM C645

Protection

Method: Hot Dip Galvanization

Quality: 98% Zinc (Zn)

Coating Classification: 60 - 180 GSM

Coating Finish: Regular, Aluzinc Surface

Surface Quality: As-coated surface (A)

Surface Treatment: Chemical Passivation (CA)

Test Items, Method and Results

Test Item	Test Requirements	Test Result	Verdict		
Reaction to fire	Shall be classified according to UKAS accredited test.	Range of Fire 30-120min	Pass		
Reaction to acoustics	Shall be classified according to UKAS accredited test.	37 - 70 dB (dependent on systems chosen)	Pass		
Flexural strength	When required, shall be determined in accordance with BS EN 10346:2009	<u>Yield Strength:</u> 300 - 400 Mpa (dependent on thickness) <u>Tensile Strength:</u> 270 - 500 Mpa (Dependent on thickness)	Pass		
Materials	The Material shall permit cold forming to produce sections that have clean cut edges and ends.	Clean cut edges and ends	Pass		
Dimension and tolerances	Length (L) \pm 3 mm Width (W) \pm 1.5 mm Thickness (T) \pm 0.025mm	All tolerances were within the limits.	Pass		
S. No	Test Item	Requirements of Standard (GI)	Test Results	Verdict	
1	Appearance quality	Main Channel	Clean cut edges and ends.	Pass	Pass
		Furring Channel	The cut should exclude burr and deformation The coating should be clear.	Pass	Pass
		Perimeter Angle		Pass	Pass
2	Coating (GSM)	Main Channel;	Z60 - 60 g/m ²	62 g/m ²	Pass
		Furring Channel	Z90 - 90 g/m ²	93 g/m ²	Pass
		&	Z120 - 120 g/m ²	120 g/m ²	Pass
		Perimeter Angle	Z180 - 180 g/m ²	181 g/m ²	Pass
3	Dimensional deviation	Main Channel	Length (L) \pm 3 mm Width (W) \pm 1.5 mm	Pass	Pass
		Furring Channel		Pass	Pass
		Perimeter Angle	Allowable thickness deviation (DT) = \pm 0.025 mm	Pass	Pass

Main Channel

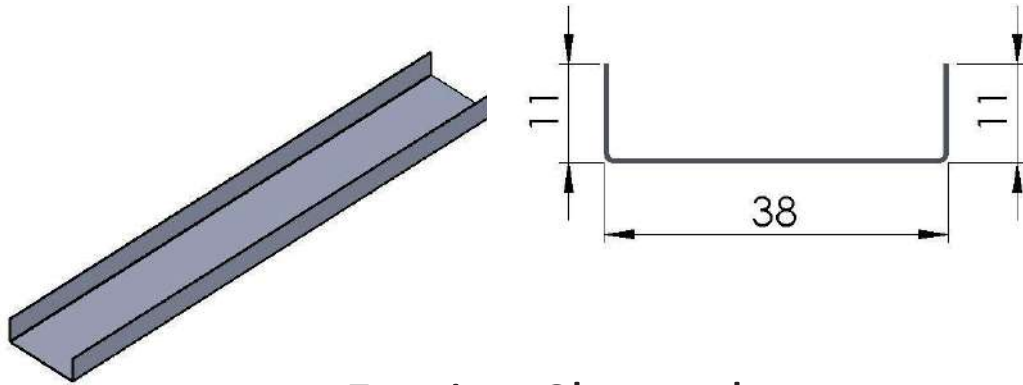

Furring Channel

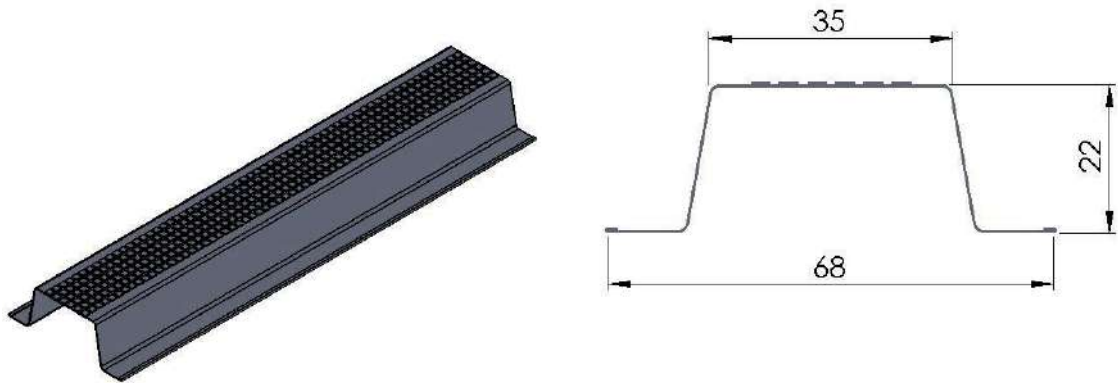

Perimeter Angle

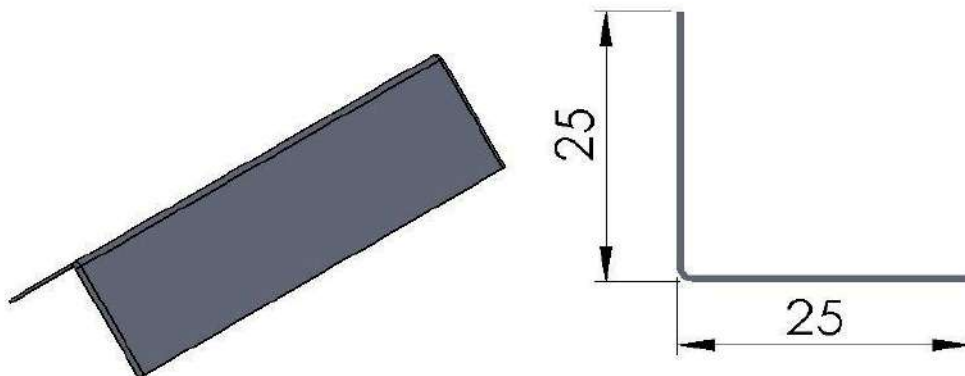

Technical Data Sheets of Dry Wall Partition System

Description of the products: Dry Wall Partition System

Applicable Standards: Galvanized / Galvalume Steel

BS EN 10346:2009 -DX51(formerly BS EN 10142:1991)

Material Identification: G.I / G.L Steels consisting of the Stud & Track (Runner).

Product Identification:



- Studs are vertical profiles inserted into the Track (Runners) bearing profiles of the partition, used for fixing of partition covering (Gypsum Boards & Fiber cement boards).
- Tracks (Runners) are horizontal profiles to fix the partition to floor and ceiling.

Product	Available width (mm)	Standard Length(mm)	Available Length(mm)	Available Thickness(mm)
Stud	39/46/50/61/68/70/ 73/90/98/123/148	3000	Up to 7000mm	0.35 - 1.0mm
Track (Runner)	41/48/52/63/70/72/ 75/92/100/125/150	3000	Up to 7000mm	0.35 - 1.0mm

Features and Uses:

- Quick to erect, lightweight and clean.
- Metal Stud is dimensionally accurate and will not twist or bow.
- Easy to cut to length using tin snips.
- Frames easily fit together.
- Door frames simply formed.

Technical Data Sheets of Dry Wall Partition System

Material Specification: Galvanized / Galvalume Steel

Mechanical Properties

Specification and Grade: ASTM A653:2018/CS Type A

Treatment: Chromated (6) & Unoiled

Yield Strength: 300 Mpa - 400 Mpa

Tensile Strength: 270 Mpa - 500 Mpa

Elongation: 22% - 37 % at 50 GL

Hardness (HRB): 60 - 65

Manufacturing Standard: ASTM C645

Protection

Method: Hot Dip Galvanization

Quality: 98% Zinc (Zn)

Coating Classification: 60-180 GSM

Coating Finish: Regular, Aluzinc Surface

Quality: As-coated surface (A)

Surface Treatment: Chemical Passivation (CA)

Test Items, Method and Results

Test Item	Test Requirements	Test Result	Verdict
Reaction to fire	Shall be classified according to UKAS accredited test.	Range of Fire 30-120min	Pass
Reaction to acoustics	Shall be classified according to UKAS accredited test.	37 - 70 dB (dependent on systems chosen)	Pass
Flexural strength	When required, shall be determined in accordance with BS EN 10346:2009	<u>Yield Strength:</u> 300 - 400 Mpa (dependent on thickness) <u>Tensile Strength:</u> 270 - 500 Mpa (dependent on thickness)	Pass
Materials	The Material shall permit cold forming to produce sections that have clean cut edges and ends.	Clean cut edges and ends	Pass
Dimension and tolerances	Length (L) \pm 3 mm Width (W) \pm 0.5mm Thickness (T) \pm 0.025mm	All tolerances were within the limits.	Pass

Technical Data Sheets of Dry Wall Partition System

S.No.	Test Item		Requirements of Standard (GI)	Test Results	Verdict
1	Appearance quality	Stud	Clean cut edges and ends. The cut should exclude burr and deformation The coating should be clear.	Pass	Pass
		Track (Runner)		Pass	Pass
2	Coating (GSM)	Stud & Track (Runner)	Z60 - 60 g/m ²	62 g/m ²	Pass
			Z90 - 90 g/m ²	93 g/m ²	Pass
			Z120 - 120 g/m ²	120 g/m ²	Pass
			Z180 - 180 g/m ²	181 g/m ²	Pass
3	Dimensional deviation	Stud	Length (L) \pm 3 mm Width (W) \pm 0.5 mm Allowable thickness deviation (DT) = \pm 0.025 mm	Pass	Pass
		Track (Runner)		Pass	Pass

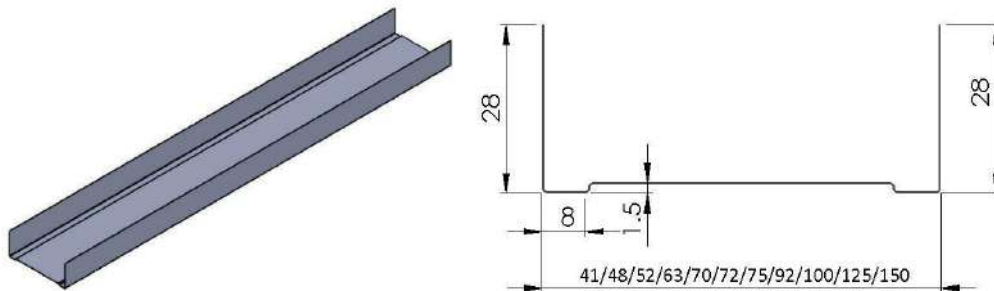
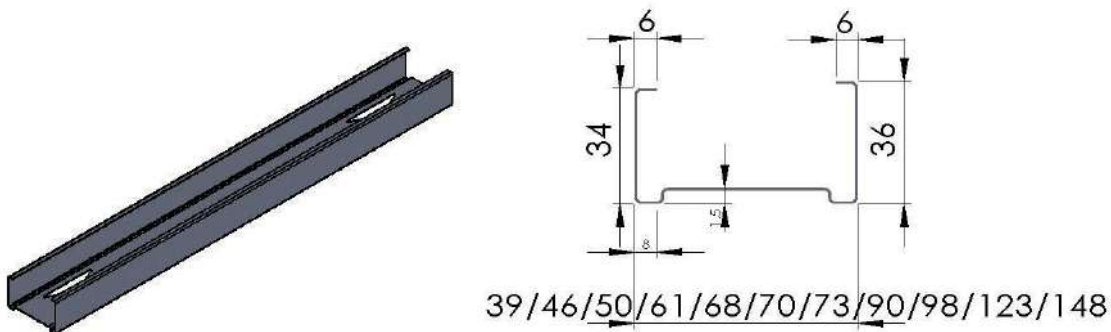

Drywall Partition System

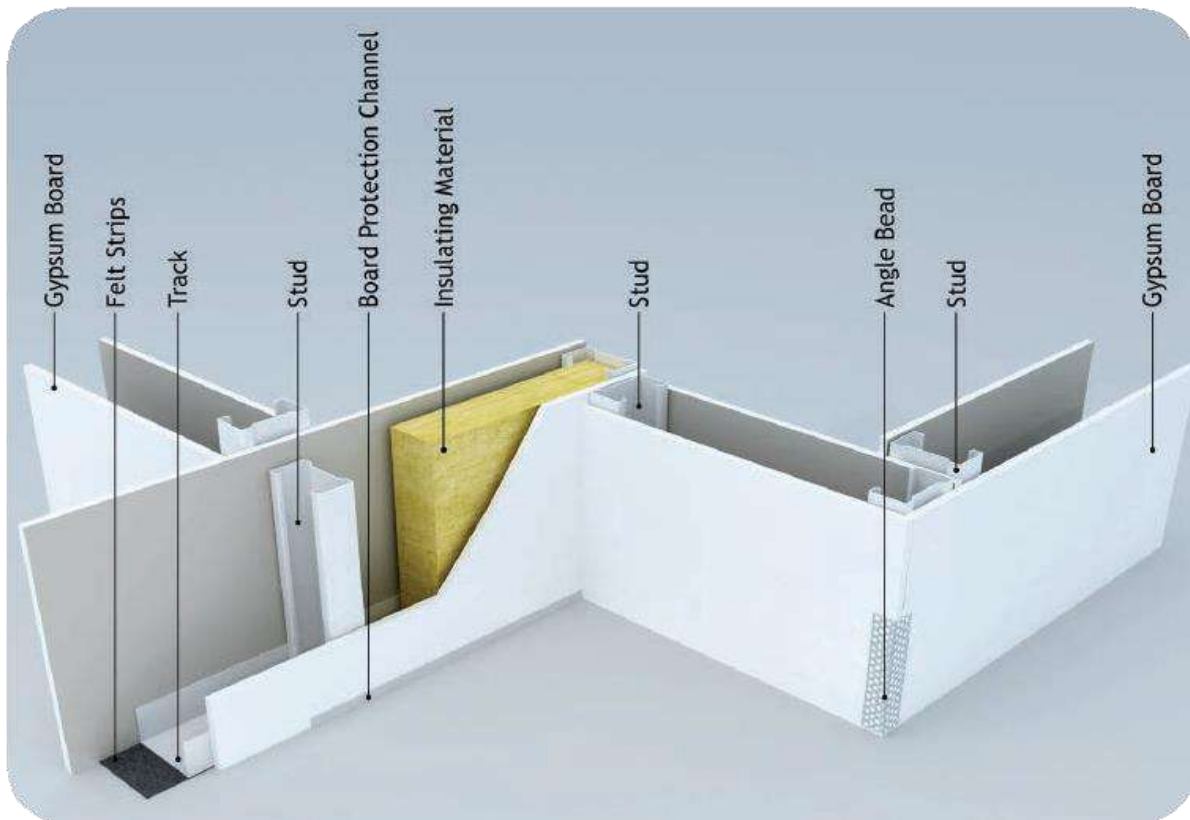

Drywall Ceiling System

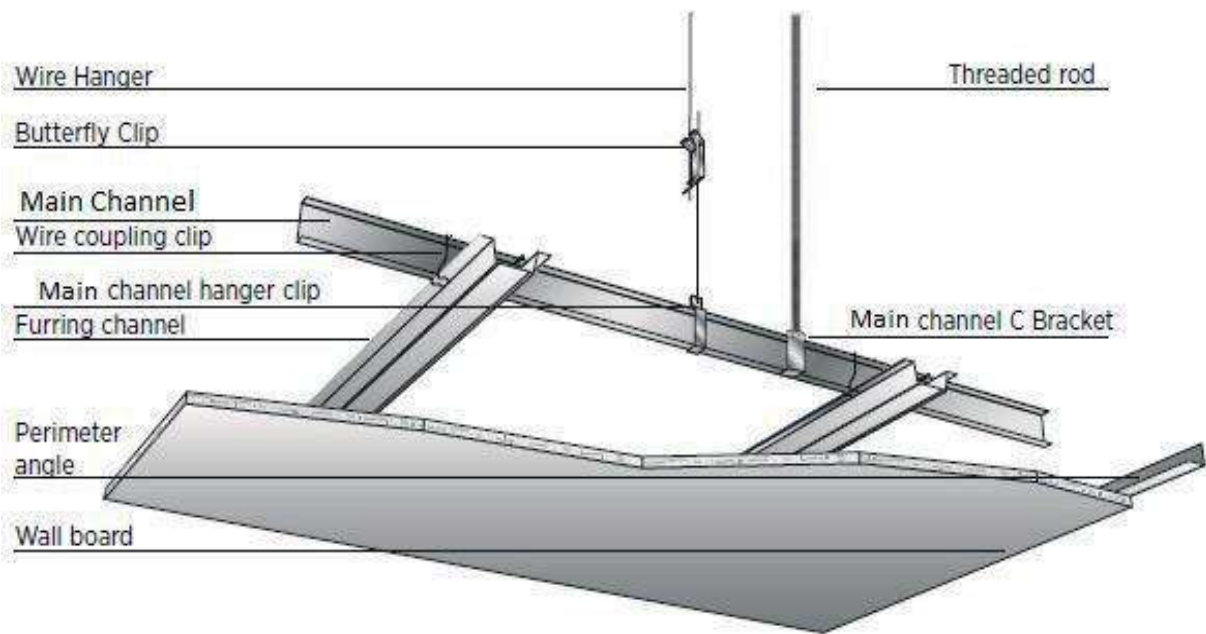

OUR OTHER PRODUCTS

-GYPSUM PLASTER BOARD (GYPCORE MADE IN OMAN)

-GYPSUM CEILING TILES (GYPCORE MADE IN OMAN)

-GYPSUM CEILING TILES (CEILO TILES MADE IN UAE)

-T GRID SUSPENSION (CEILO GRID MADE IN UAE)

-GYPSUM PLASTER BOARD (GYPLINE MADE IN UAE)

-GYPSUM ACCESS PANEL (PROAXS MADE IN UAE)

-ALUMINIUM CEILING TILES (CARTEL MADE IN UAE)

-GYPSUM ACCESS PANEL (JINI MADE IN INDIA)

-MAARK DRYWALL SCREWS (MADE IN INDIA)

-FIBRE CEMENT BOARD (VISAKA MADE IN INDIA)

-GREENLAM LAMINATES (MADE IN INDIA)

-NEW MIKA LAMINATES (MADE IN INDIA)

-GYPSUM ACCESSORIES



KINGDOM OF CARGO & TRADING

P.O BOX: 1715 P.C: 122

AL MAABELA, SULTANATE OF OMAN

PH: +968 24264563

GSM: +968 9332 9434 +968 9222 8473 

E MAIL: bmdkingdom@gmail.com

WEB: www.kctoman.com